

Città ideale e felicità reale

workshop di
Giovanni Papi

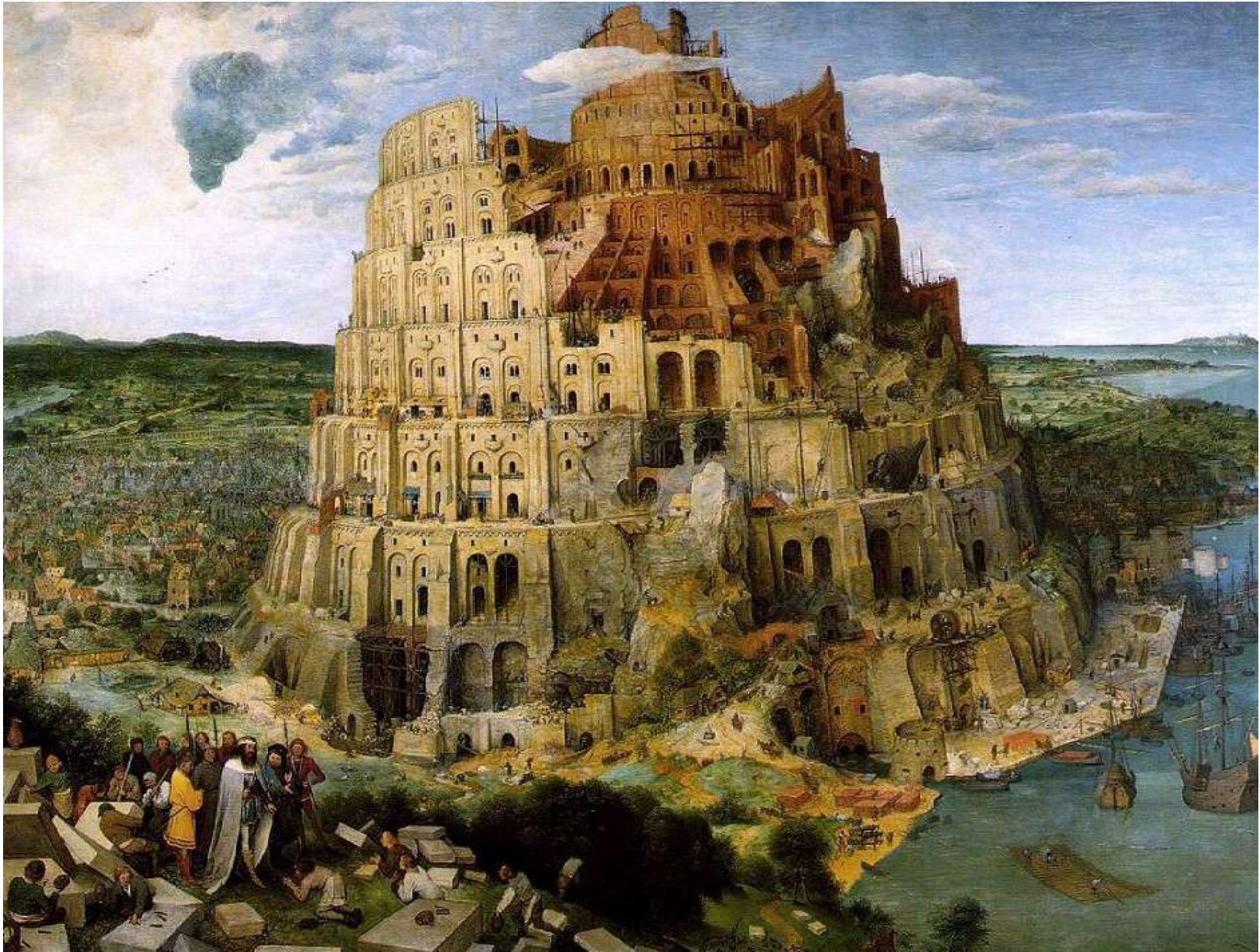





NINE





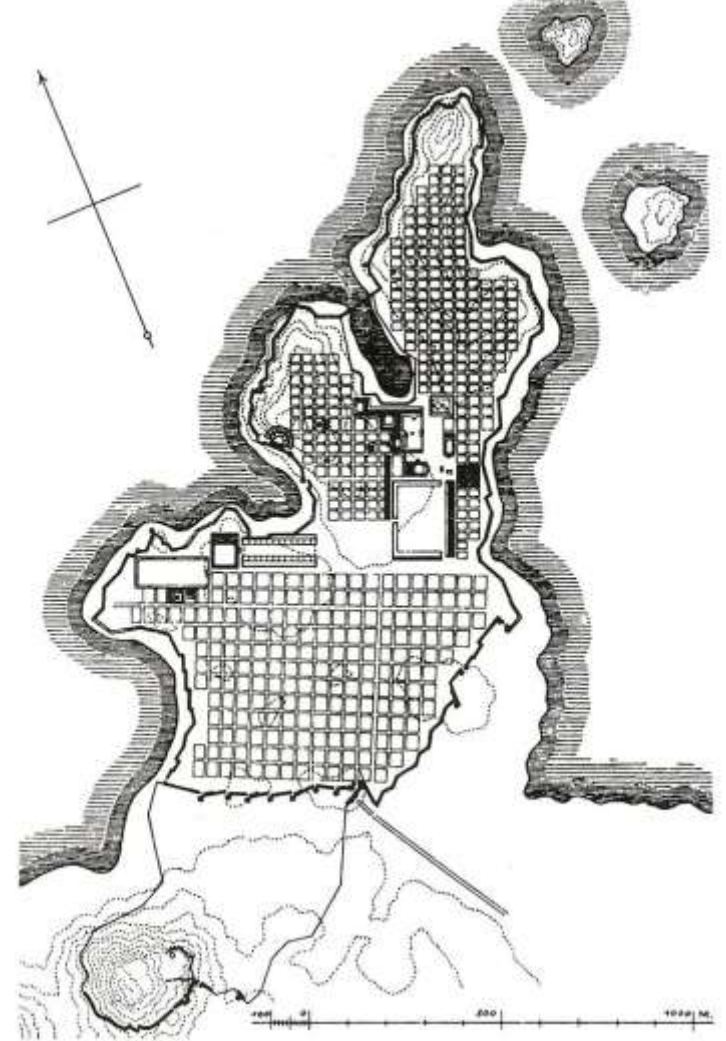



Lorenzetti, *Il Buon Governo* – Siena, 1338











Città ideale - Urbino



Città ideale - Baltimora



Città ideale - Berlino



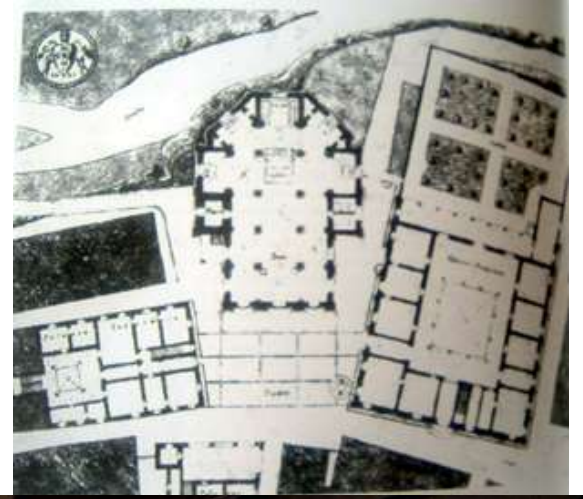









Pienza

- in alto: veduta aerea

- in basso a sx: Il Duomo e il Palazzo Piccolomini

- in basso a dx: pianta degli interventi quattrocenteschi

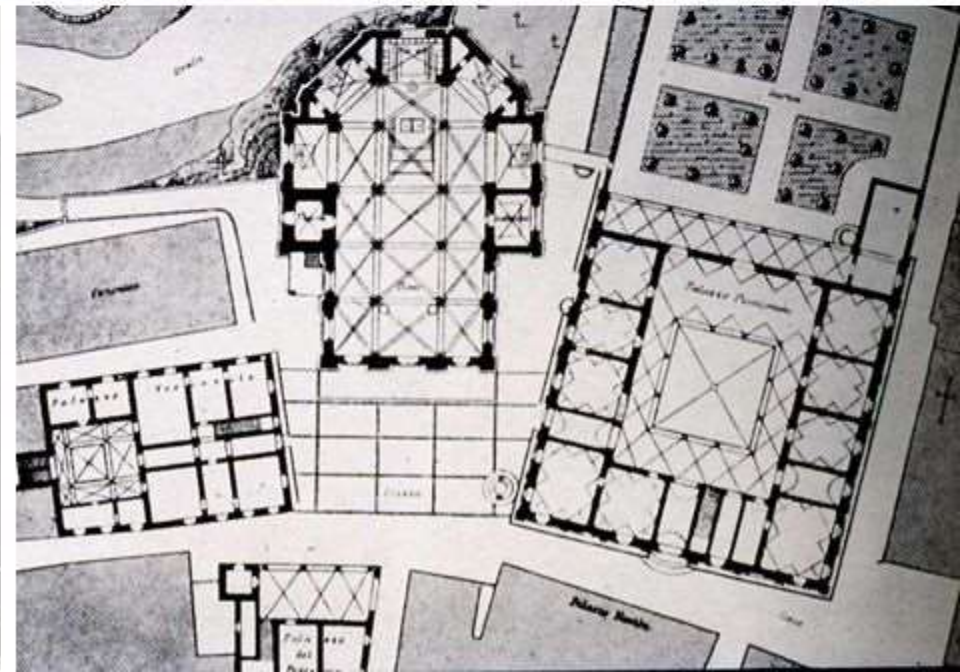

MANTVA.



Mantua, Lombardie Transpadanae
ne urbs clarissima et antiquissima
venerabilissima, in medio paludum
situm obtinet Anno salutis MD.
D. LXXV. ad viam delineata.





































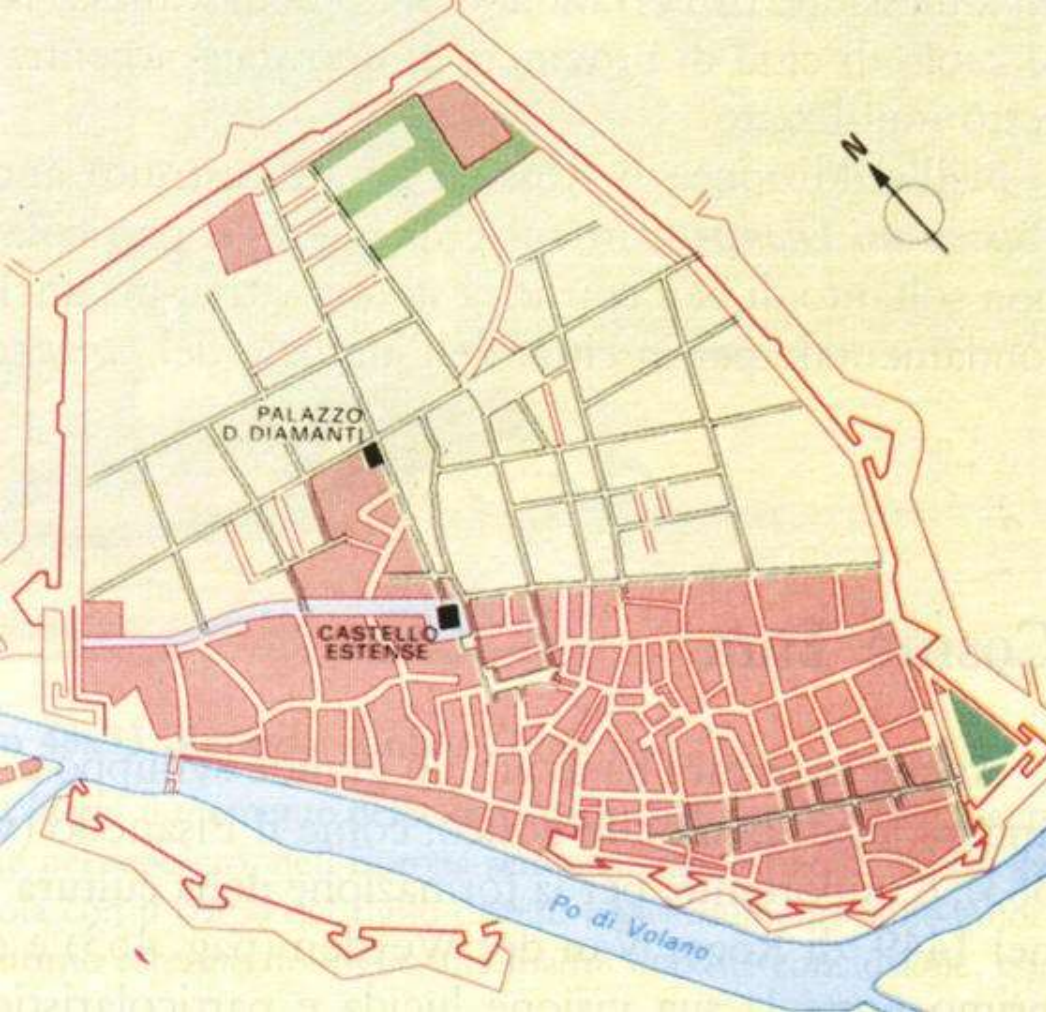

FERRARIA.



1. Ara.
2. Palæta nobilis.
3. Germanorum castra.
4. Holmorum stibula.
5. Armarum stibula.
6. Horu' Vitis.
7. Herules II. Bassi staba.
8. Curia.
9. Basilica Cathedralis.
10. Ferraria Salernorum.
11. Templ. S. Donato.
12. Corticellorum.
13. S. Benedicti.
14. Mastellæ.
15. Templ. S. Pauli.
16. Porta S. Pauli.
17. Dogana.
18. S. Romani.
19. Porta S. Romanæ.
20. Palæta Bonaldorum.
21. Egredia Duce.
22. Palæta Adamantianæ.
23. Xenodoch. S. Anna.
24. Templ. S. Gabrielis.
25. S. Crastis.
26. D. Catharina Senensis.
27. S. Joannis Baptistæ.
28. S. Spiridus.
29. S. Barbara.
30. S. Bernardi.
31. S. Regis.
32. S. Regis.
33. Consistoria.









NOVA PALMAE ciuitas in patria Ferouidensi ad mari Adriatici officium contra Barbarorum incursum a Venetis aedificata

Propugnacula ciuitatis novae, quae a se invicem distant 200 passibus. Circa haec plures excubitorum pro armando sunt. Ipsi quoque cum militibus legum sunt passus 10. Profunditas 15. Turres habet tres, et arces 9. Haec in propugnaculis ad circumferentiam, in quo turris singulis, ciuitatis custodiam. Igitur dicitur 600 passibus.



